

RESOLUTION NUMBER 14-016

**A RESOLUTION OF THE MAYOR AND CITY COUNCIL OF THE CITY OF SAFFORD,
GRAHAM COUNTY, ARIZONA RESTRICTING THIRTEEN INDIVIDUAL PARKING
SPACES TO TWO-HOUR PARKING WITHIN THE NEW PARKING LOT AT FIRTH PARK.**

WHEREAS, pursuant to Section 10.12.100 Municipal Parking Lots, of *the City of Safford Municipal Code*, the City Council may, *by resolution, place restrictions as it deems necessary on parking for all or a portion of any municipal parking lot or individual spaces within a lot, and shall cause such restrictions to be posted in proximity to the affected location*; and,

WHEREAS, the Mayor and City Council of the City of Safford desires to restrict thirteen (13) individual parking spaces to two-hour parking for Park users only within the new parking lot at Firth Park in Safford to promote public Park use; and

WHEREAS, the City of Safford will restrict parking through striping and no parking signs to be installed as indicated in "Exhibit A"; and,

NOW THEREFORE BE IT RESOLVED, by the Mayor and City Council of the City of Safford, to restrict thirteen (13) individual parking spaces to two-hour parking for Park users only within the new parking lot at Firth Park as indicated in "Exhibit B".

PASSED, ADOPTED AND APPROVED by the Mayor and City Council of the City of Safford this 24th day of March, 2014.

Wyn "Chris" Gibbs
Mayor

ATTEST:

APPROVED AS TO FORM:

Georgia Luster, MMC
City Clerk

William J. Sims, III
Interim City Attorney

CERTIFICATION

STATE OF ARIZONA)
) ss
County of Graham)

I HEREBY CERTIFY, that the foregoing Resolution Number 14-016 was duly passed and adopted by the Mayor and City Council of the City of Safford, Graham County, Arizona, at a special council meeting held March 24, 2014. A quorum of the Council was present at the meeting.

Georgia Luster, MMC, City Clerk

March 24, 2014
Date

“EXHIBIT A”

**RESERVED FOR
PARK USERS ONLY
2-HOUR PARKING**

Ordinance Number: 00-004

Resolution Number: 14-016

"EXHIBIT B"

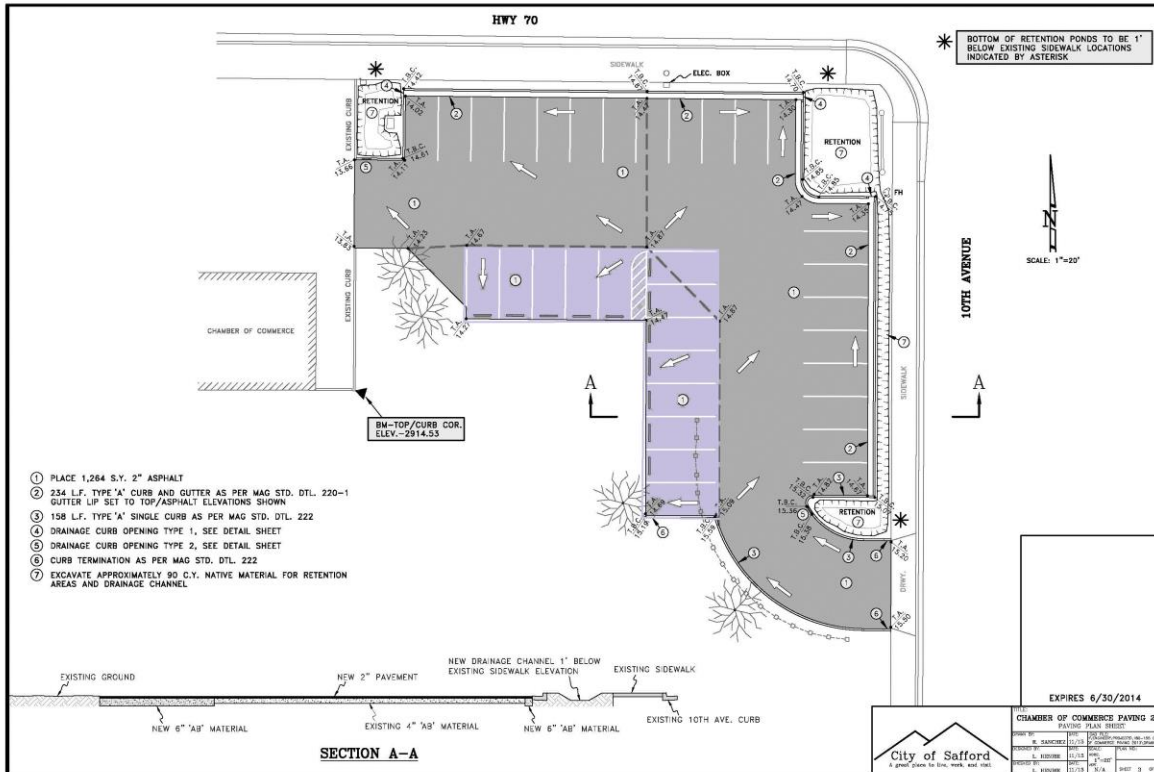

* BOTTOM OF RETENTION PONDS TO BE 1' BELOW EXISTING SIDEWALK LOCATIONS INDICATED BY ASTERISK

SCALE: 1"=20'

10TH AVENUE

SECTION A-A

EXPIRES 6/30/2014

City of Safford
 CHAMBER OF COMMERCE PAVING RC
 PAVING PLAN SHEET
 PROJECT NO. 2012-002
 DATE 01/18/12
 DRAWN BY J. B. BROWN
 CHECKED BY J. B. BROWN
 APPROVED BY J. B. BROWN
 CITY OF SAFFORD